

# Rim Locks - Standard Security

1028 / L1028

## Standard Stile Cylinder Night Latch



ASSA ABLOY

### Application:

- For timber doors from 35-60mm thick, hinged on the left or right and opening inwards. See variants for doors opening outwards
- Concealed fixing
- Not recommended for glass panelled doors
- Also suitable for steel and composite doors - special fixings required

### Specification:

- The bolt is withdrawn by key outside and handle inside
- The bolt may be held in the locked or in the withdrawn position by operating the snib
- Backset: 60mm
- Case & Keep: Zinc
- Latch Bolt: Anodised Brass finish
- Handle: Zinc, finished to match case and keep material
- Outside Cylinder: Brass, 5 pin tumbler mechanism
- Inside Cylinder: n/a
- Keying Groups: May be supplied to pass, differ & master keyed. Supplied with 2 steel nickel plated keys as standard
- To pass products - order JP1X1 cylinder separately
- Master keyed products supplied with nickel silver keys - order JM1X1 cylinder separately
- Key Blank Number: KB8-NP
- Available Boxed or Visi Packed

### Finish:

- CG - Champagne Gold
- EB - Enamelled Brass
- SC - Satin Chrome
- WE - White Enamel
- CH - Chrome
- PL - Polished Brass



# Rim Locks - Standard Security

1028 / L1028

## Standard Stile Cylinder Night Latch



ASSA ABLOY

### Technical Design:

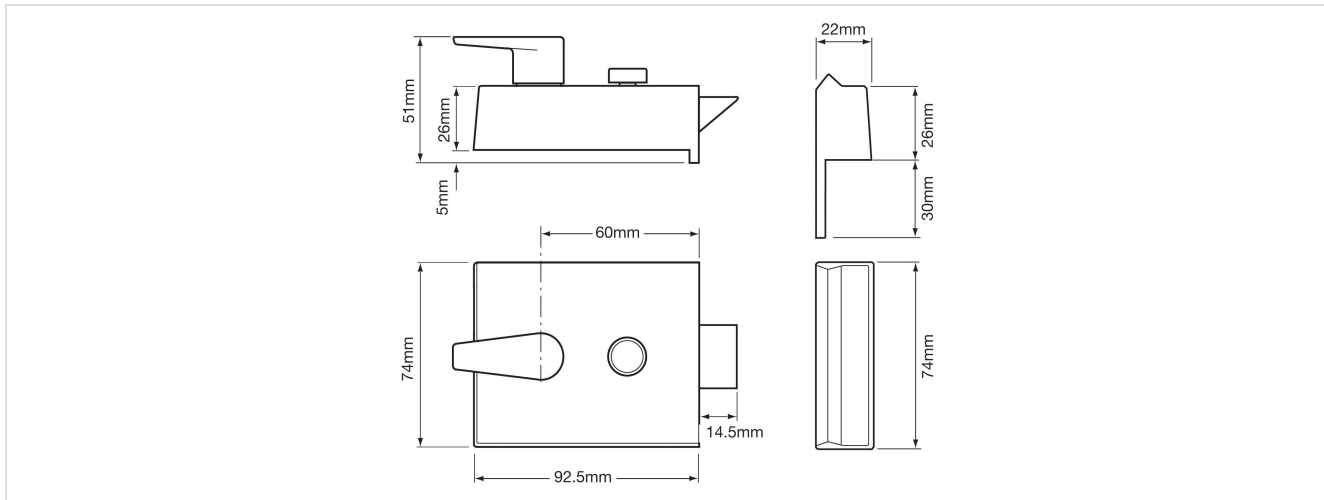

### Variants:

Code	Description
Y1028-CG-PL	Standard Security Rim Lock - Visi
Y1028-CG-SC	Standard Security Rim Lock - Visi
Y1028-CH-CH	Standard Security Rim Lock - Visi
Y1028-EB-PL	Standard Security Rim Lock - Visi
Y1028-SC-SC	Standard Security Rim Lock - Visi
JL1028-CG	Standard Security Rim Lock - Case Only
JL1028-CH	Standard Security Rim Lock - Case Only
JL1028-EB	Standard Security Rim Lock - Case Only
JL1028-SC	Standard Security Rim Lock - Case Only
JL1028-WE	Standard Security Rim Lock - Case Only